



Magnetic drive pumps
MDE



**Magnetic Drive Pumps for
Chemical Processing**

The Heart of Industry

The World's Largest-Class Non-Metallic Magnetic Drive Pumps for Chemical Processing

The MDE Series comprises the world's largest-class non-metallic magnetic drive pumps for chemical processing, with a maximum delivery of 4.0m³/min. and a maximum head of over 70 meters. The liquid end parts, plastics are made of advanced corrosion-resistant materials such as fluororesins and fine ceramics, and the major fluoroplastic-made parts are reinforced with special metal inserts for added mechanical strength and durability. These pumps have a maximum casing-pressure resistance of 1.6 MPa.



Strong Corrosion Resistance

Fluoroplastic and fine ceramic are used in the liquid end parts. These materials enable strong acids, strong alkalines, and virtually all chemical solutions to be handled.



High Levels of Durability

The exterior of the pumps is covered with ductile cast iron (FCD400). Ample pressure resistance has been provided in the rear casing through the adoption of a unique shape that prevents the concentration of stress, and a dual structure reinforced with an FRP cover. In addition, the spindle and magnet capsule, which are subject to the repetitive stress of rotational vibration, are made of fluororesin with special metal inserts. These are thus built to withstand sustained operation over an extended period under harsh service conditions.



Compliant with standards ISO

The basic performance, dimensions, and other particulars of the pumps are in compliance with the international standard (ISO2858, 3661, 5199).

They are interchangeable with general-purpose centrifugal pumps.

Note: Model MDE 125-250 is excluded.

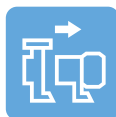

Back pullout construction

The pumps have back pullout construction, enabling their internals to be inspected or their component parts to be replaced without disconnecting associated piping. Moreover, the simplified construction consisting of unit components makes maintenance and inspection easy.

Examples of applications

• CHEMICALS

Soda industry (manufacture of hydrochloric and hypochlorous acids, as well as their secondary products), manufacture of hydrofluoric acids and fluorides, manufacture of chemical fertilizers, circulation of reaction liquid in gas-absorption towers, oil refining (sulfuric acid), use in waste-acid recovery and regeneration facilities, and transfer and supply of strong acids to tank trucks at general chemical plants

• PHARMACEUTICALS

Manufacture of high purity chemicals for semiconductors, manufacture of agricultural chemicals, use in factories for the synthesis of medicine, and manufacture of chemicals for water treatment

• PLATING

Recycle filtration of plating liquid for various plating systems

• ELECTRICAL APPLIANCES

Manufacture of electrolytic capacitors (etching of aluminum film), transfer of electrolytic liquid for storage batteries and dry cells, etching of printed wiring boards, and transfer of pure chemicals for semiconductors

• METAL INDUSTRY

Use in alumite treatment facilities, degreasing and pickling at wire elongation plants and steel-rolling mills, use in facilities for the prepainting treatment of vehicles (degreasing and acid washing), and use in factories for the manufacture of titanium oxide, rare-earth elements, etc.

• MINING

Metal smelting (transfer and circulation of electrolytic liquid) and scrubber treatment of waste gases

• FOOD INDUSTRY

Manufacture of monosodium glutamate (hydrochloric acid), refining of edible oils (sulfuric acid), and use in fruit-canning plants (hydrochloric acid)

• WATER TREATMENT

Washing of ion-exchange resins, and use in pure-water production facilities and salt-to-fresh brine distillation facilities

• POLLUTION CONTROL

Charging of wastewater treatment chemicals into injection tanks, collection and transfer of waste liquid, and use in gas adsorption facilities (deodorization equipment, desulfurization of flue gas, etc.)

Liquid end materials

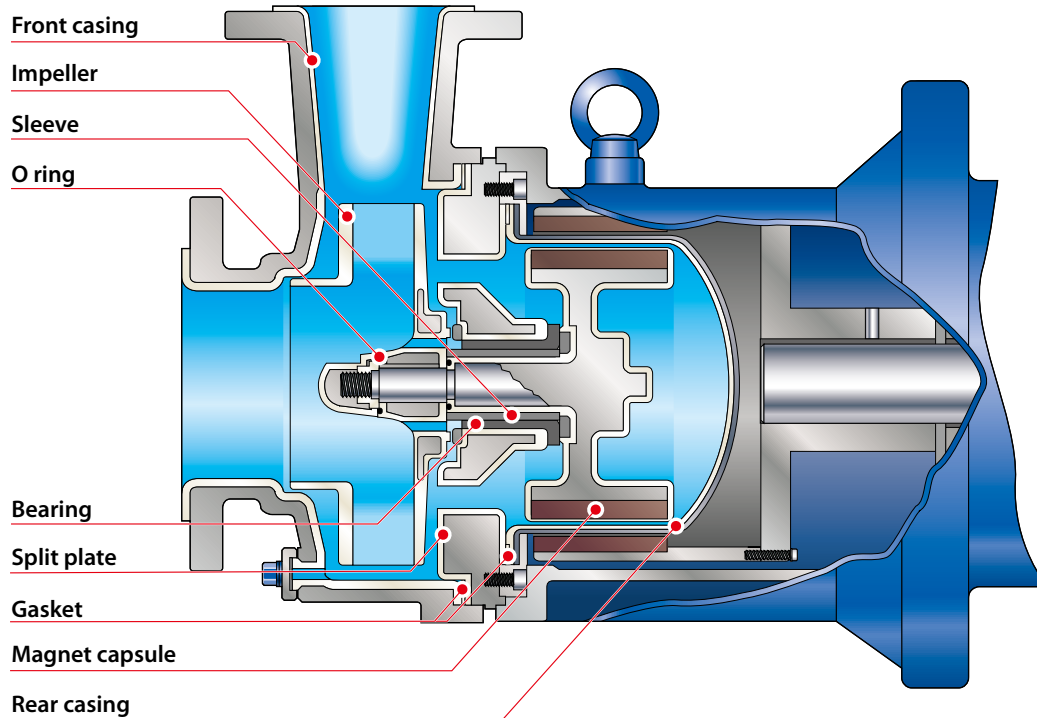

Part name	Material
Front casing	ETFE
Rear casing	PFA
Impeller	CFRETFE
Split plate	PFA
Maget capsule	
Bearing	SiC
Sleeve	
Gasket	PTFE
O-Ring ^{Note}	Kalrez®

Note: FKM/EPDM are also available on request.



MDE125

Construction and materials

Rear casing

The base of this component has a unique downed shape that prevents stress concentration. In addition, this component is reinforced with an FRP cover to provide the required pressure resistance. It is also designed to maximise safety by preventing sparks from being discharged if it is accidentally contacted by the drive magnet.



Split plate

This is made of fluororesin with a mold-in ductile cast steel insert. Its sturdy construction supports the rotor assembly rigidly. Moreover, it has a back-flow port that is effective in cooling the bearing parts and discharging slurry.



Impeller

The impeller with integral shroud has a molded-in metal reinforcing insert. Mechanical strength and pumping efficiency have been improved over previous types.



Magnet capsule

The metal shaft and rare-earth magnet have a hermetically molded fluoroplastic cover. It has excellent durability and produces high torque.



Bearing / Sleeve

The use of SiC for these parts maximises their abrasion resistance, impact resistance, and heat resistance. The sleeve system has been adopted to ease maintenance and replacement and reduce costs.



Modular construction

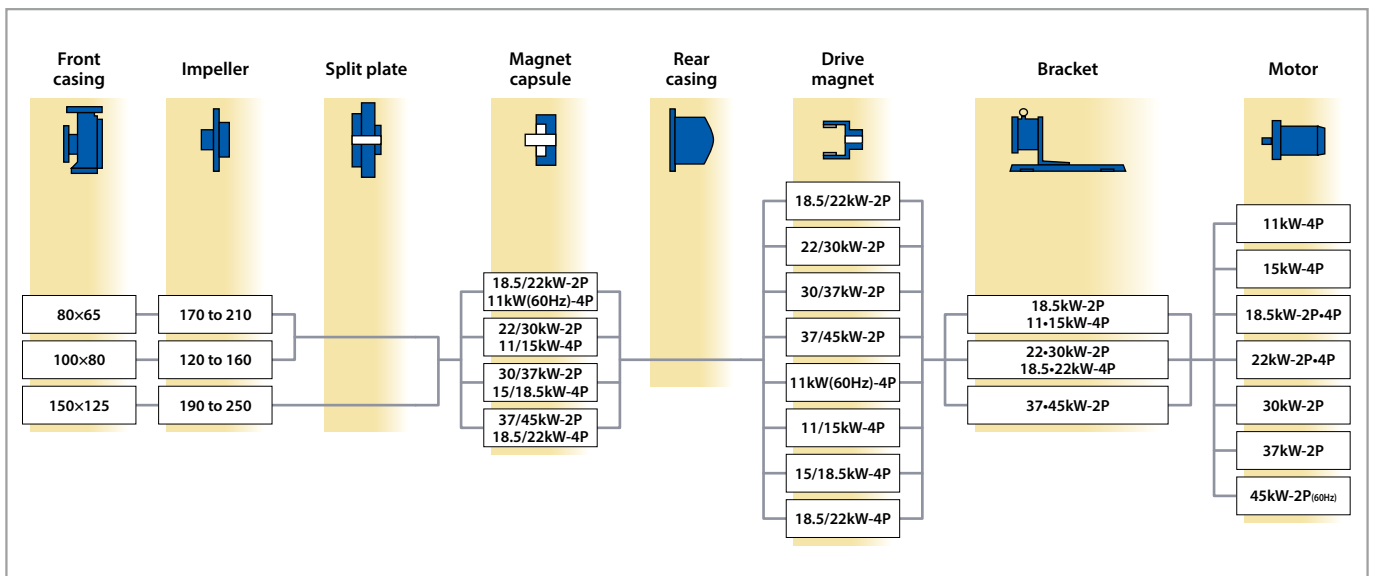

Performance curves

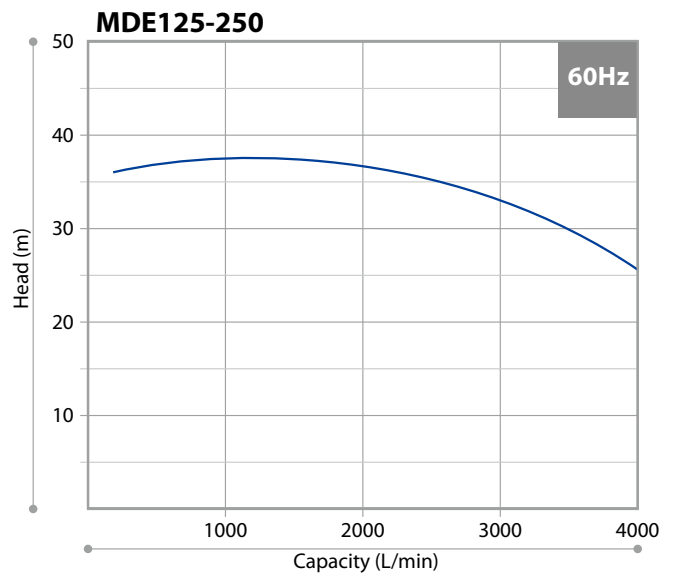
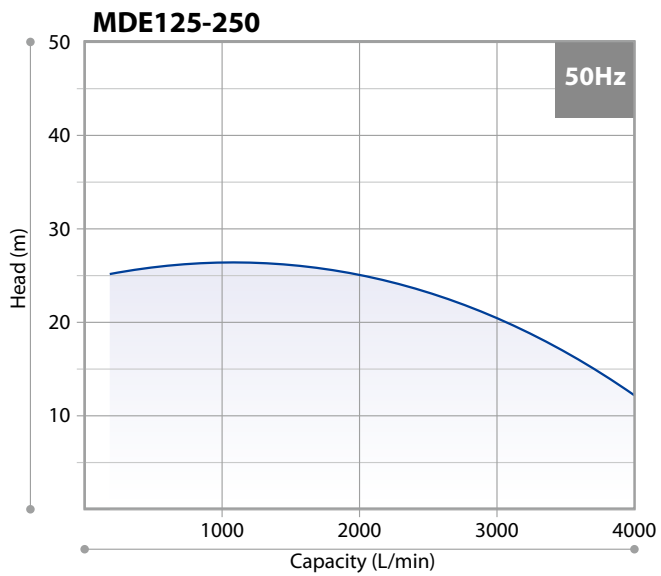
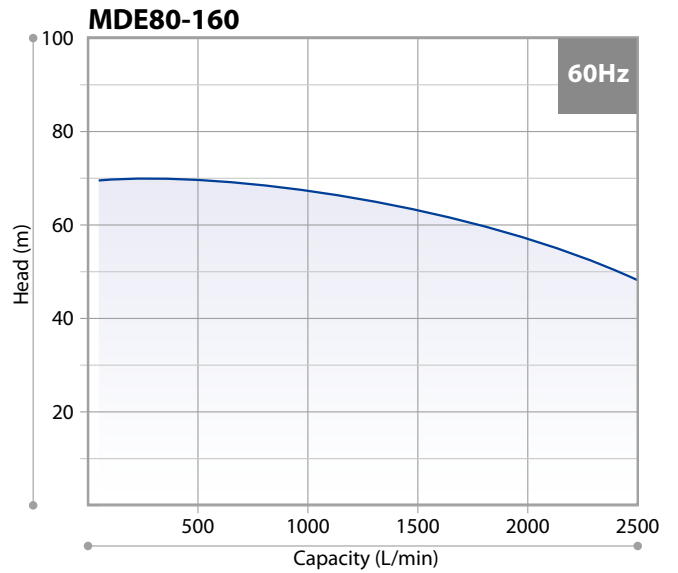
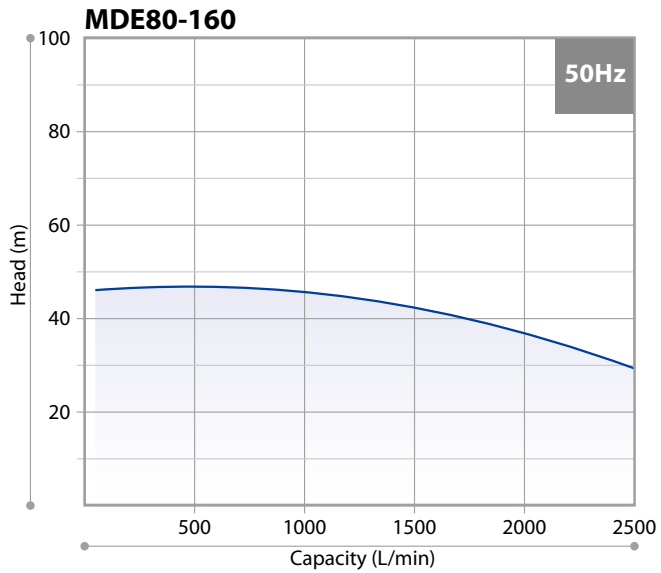
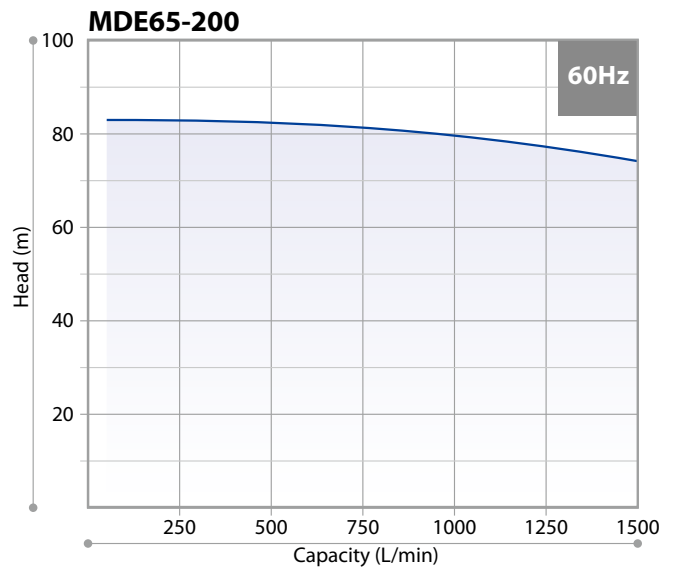
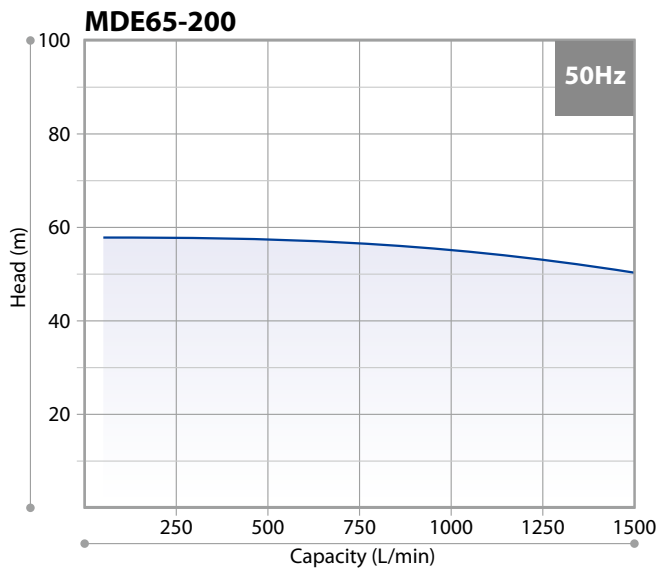

Specifications

Models	Nominal bore size Inlet×Outlet	50Hz		60Hz	
		Capacity L/min	Head m	Capacity L/min	Head m
MDE65-200(2P)	80A×65A	833	53.0	1000	75.0
MDE80-160(2P)	100A×80A	1670	38.0	2000	53.5
MDE125-250(4P)	150A×125A	2400	22.5	3000	32.0

Expected performance in normal temperature, the clear water.

Common specifications

Temperature range of liquid handled: 0 to 100°C

Allowable slurry: For this information, please contact us.

Pump identification

MDE **65** - **200** **E** **K** **Z** **F** **370** **J** - **D** **2**

1
2
3
4
5
6
7
8
9
10

1 Pump size
65, 80, 125

2 Impeller size
160 to 250

3 Wet-end main material
E : ETFE

4 Material of Sleeve/Bearing
K : SiC/SiC

5 Material of O-ring
Z : Kalrez®
V : FKM
E : EPDM

6 Type of motor
F : Flange mounted type motor

7 Motor output
110 to 450 : 11 to 45kW^{Note1}
Note1: 45kW supports only 60Hz

8 Pump standard
J : JIS flange+JIS motor
I : ISO flange+IEC motor
A : ANSI flange+JIS motor or IEC motor^{Note2}
Note2: If you select "A", it is a special version.
Please select Mark "S" or "X" in the Item 9 Special version.

9 Special version

Mark	Drain	Base	Special version
A	Without drain	With base	Standard
S	Without drain	With base	Special
D	With drain	With base	Standard
X	With drain	With base	Special

10 Motor poles

2 : 2P
4 : 4P^{Note3}
Note3: MDE125-250 type is 4P only.

Dimensions in mm

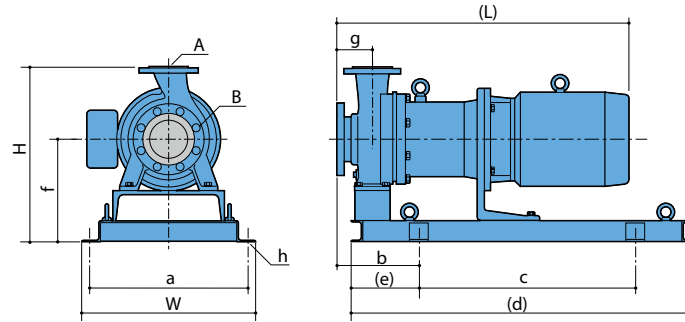

Type	Motor kW	W	H	(L)	a	b	c	(d)	(e)	f	g	h	A	B	mm
															Mass kg
MDE65-200	18.5	610	555	972	550	275	740	1200	230	355	100	4-φ27	65A	80A	275
	22			1023											355
	30			1061											445
	37			1119											515
	45														
MDE80-160	18.5	610	555	972	550	255	740	1200	230	355	100	4-φ27	80A	100A	280
	22			1023											355
	30			1061											445
	37			1119											515
	45														
MDE120-250 (4P)	11	610	645	994	550	280	740	1200	230	355	140	4-φ27	125A	150A	305
	15			1038											310
	18.5			1063											410
	22			1101											470
	30														

Note: The dimensions and mass may differ with the type of motor installed.

Optional accessories

Iwaki pump protector DRN series

Detects unusual pump operating conditions including dry-running and overload

The DRN model protects equipment (including pumps) from damage!

Minimizes production downtime.

Identifies possible causes of alarms so they can be investigated and addressed.

Multiple Input	Two analog, one digital, one temperature input and one current input
Easy operation	Equipped with EASY setup mode to remember the operation status and set the lower/upper limit values, as well as AUTO setup mode
Bar graph	Visible indication of current operating status
Logging capability	Data log feature for preventative maintenance scheduling
Communication	RS485 external communication capability



Specifications

Model	DRN-01	DRN-02
Amperometric range	0.5-30.00A	5.0-200.0A
Unit's source voltage	AC100-240V 50/60Hz 10VA	
Operating temperature	0-40°C	
Operating humidity	35-85%RH	

IWAKI Process Magnetic Drive Pump series

MDM SERIES

Magnetic drive process pumps
with dry running capability

Specifications

- Max. discharge capacity: 1800 L/min
- Max. head: 74/107 m
- Main materials: CFRETFE/PFA
- Liquid temp. range: -20 to 105°C (CFRETFE), -20 to 150°C (PFA)



MXM SERIES

Magnetic drive pumps
with an excellent balance of features and performance

Specifications

- Max. discharge capacity: 400 L/min
- Max. head: 25/41 m
- Main materials: CFRETFE
- Liquid temp. range: -10 to 105°C



MX SERIES

Withstands difficult operating conditions
and offers high efficiency

Specifications

- Max. discharge capacity: 800 L/min
- Max. head: 35/36 m (MX), 22.8/23.1 m (MX-F)
- Main materials: GFRPP (MX), CFRETFE (MX-F)
- Liquid temp. range: 0 to 80°C



SMX SERIES

Versatile self-priming magnetic drive pump
with enhanced durability under abnormal operation

Specifications

- Max. discharge capacity: 440/520 L/min
- Max. head: 18/26 m (SMX), 16/24 m (SMX-F)
- Main materials: GFRPP (SMX), GFRPP (SMX-F)
- Liquid temp. range: 0 to 80°C



IWAKI CO., LTD. 6-6 Kanda-Sudacho 2-chome Chiyoda-ku Tokyo 101-8558 Japan TEL : (81)3 3254 2935 FAX : 3 3252 8892

IWAKI has global net work.
Please find your distributor location at

www.iwakiumps.jp

European office : IWAKI Europe GmbH
Germany : IWAKI Europe GmbH
Holland : IWAKI Europe GmbH (Netherlands Branch)
Italy : IWAKI Europe GmbH (Italy Branch)
Spain : IWAKI Europe GmbH (Spain Branch)
Belgium : IWAKI Belgium N.V.
Denmark : IWAKI Nordic A/S
Finland : IWAKI Suomi Oy
France : IWAKI France S.A.
Norway : IWAKI Norge AS
Sweden : IWAKI Sverige AB

TEL: (49)2154 9254 0
TEL: (49)2154 9254 50
TEL: (31)74 2420011
TEL: (39)0444 371115
TEL: (34)93 37 70 198
TEL: (32)13 67 02 00
TEL: (45)48 24 2345
TEL: (358)9 2745810
TEL: (33)1 69 63 33 70
TEL: (47)23 38 49 00
TEL: (46)8 511 72900

FAX: 2154 9254 48
FAX: 2154 9254 55
FAX: (49)2154 9254448
FAX: 0444 335350
FAX: 93 47 40 991
FAX: 13 67 20 30

FAX: 1 64 49 92 73

() Country codes

U.S.A. : IWAKI America Inc.
Argentina : IWAKI America Inc. (Argentina Branch)
Brasil : IWAKI Do Brasil Comercio De Bombas Hidraulicas LTDA.
Singapore : IWAKI Singapore Pte Ltd.
Indonesia : IWAKI Singapore (Indonesia Office)
Malaysia : IWAKI Sdn. Bhd.
Australia : IWAKI Pumps Australia Pty Ltd.
China : IWAKI Pumps Co., Ltd.
China : GFITZ IWAKI Engineering & Trading Co., Ltd.
IWAKI Pumps (Shanghai) Co., Ltd.
Korea : IWAKI Korea Co., Ltd.
Taiwan : IWAKI Pumps Taiwan Co., Ltd.
Thailand : IWAKI (Thailand) Co., Ltd.

TEL: (1)508 429 1440
TEL: (54)11 4745 4116
TEL: (55)19 3244 5900
TEL: (65)6316 2028
TEL: (62)21 6906606
TEL: (60)3 7803 8807
TEL: (61)2 9899 2411
TEL: (852)2607 1168
TEL: (86)20 84350603
TEL: (86)21 6272 7502
TEL: (86)21 6272 7502
TEL: (82)2 2630 4800
TEL: (886)2 8227 6900
TEL: (66)2 322 2471

FAX: 508 429 1386
FAX: 19 3244 5900
FAX: 6316 3221
FAX: 21 6906612
FAX: 3 7803 4800
FAX: 2 9899 2421
FAX: 2607 1000
FAX: 20 84359181
FAX: 21 6272 6929
FAX: 2 2630 4801
FAX: 2 8227 6818
FAX: 2 322 2477

Caution for safety use:
Before use of pump, read instruction manual carefully to use the product correctly.

Legal attention related to export.

Our products and/or parts of products fall in the category of goods contained in control list of international regime for export control. Please be reminded that export license could be required when products are exported due to export control regulations of countries.

Actual pumps may differ from the photos. Specifications and dimensions are subject to change without prior notice. For further details please contact us.

The posting and copying from this catalogue without permission is not accepted firmly.